



“

2014 9 10

—

13.

”

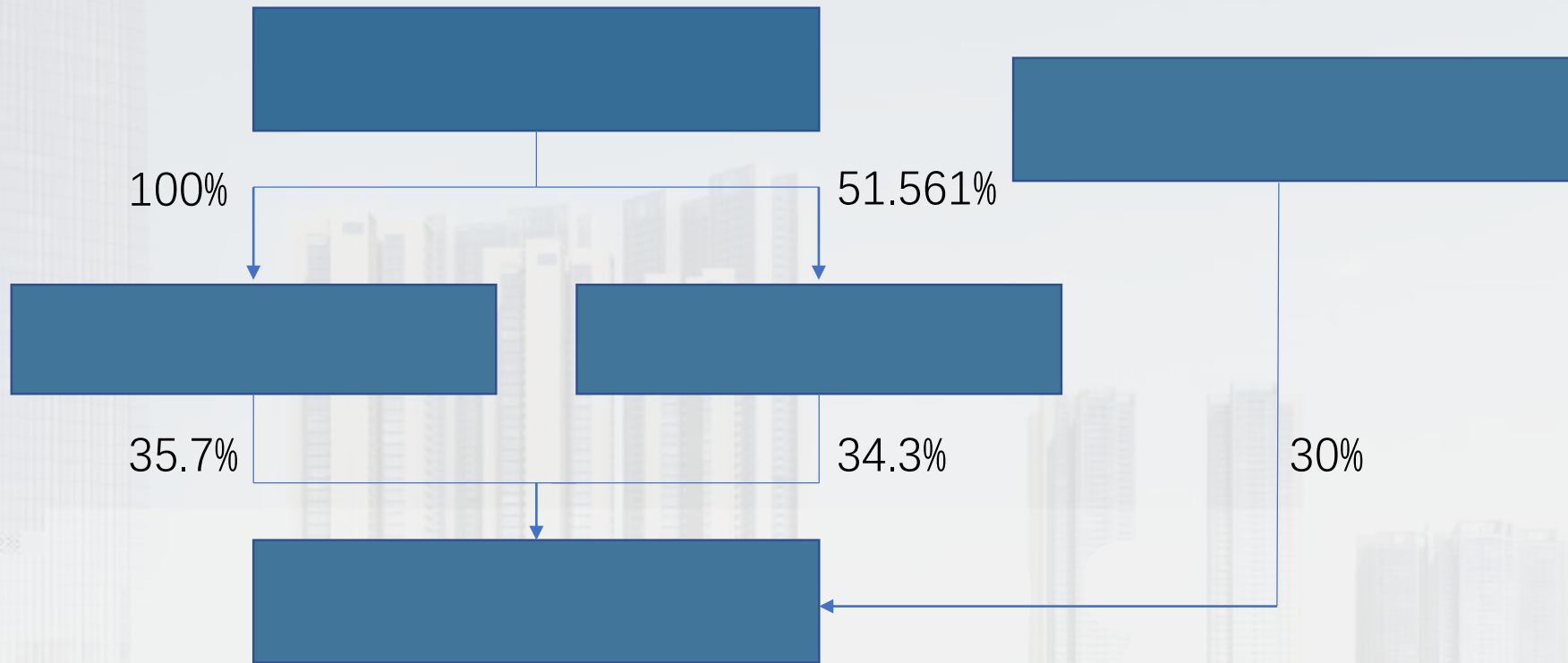



CBD

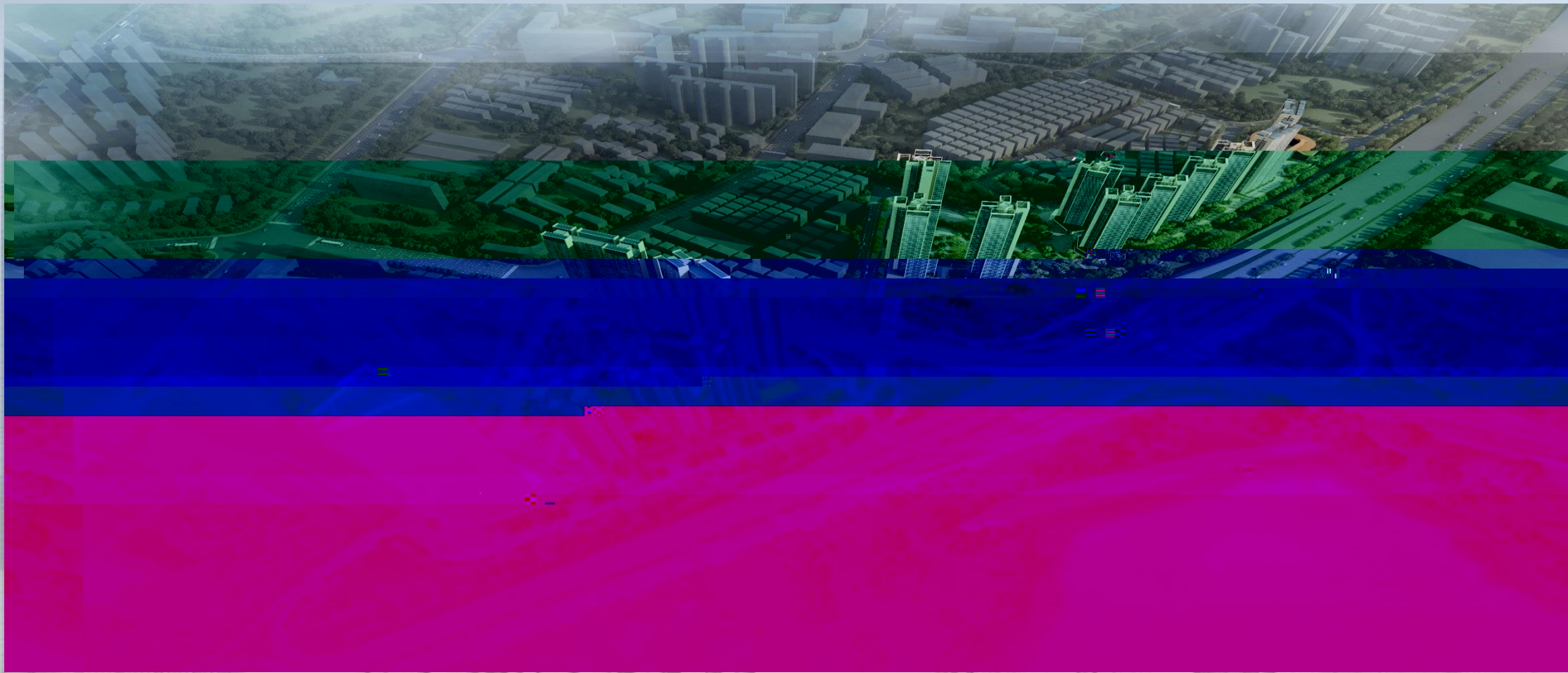

41820	96000	490265.77	245603	910	4800
937	1975.77m <sup>2</sup>	112000	78000	34460	2019
	10600	126			

116744m<sup>2</sup> (  
41820m<sup>2</sup>) 74924  
m<sup>2</sup> 4000m<sup>2</sup>  
4800m<sup>2</sup>

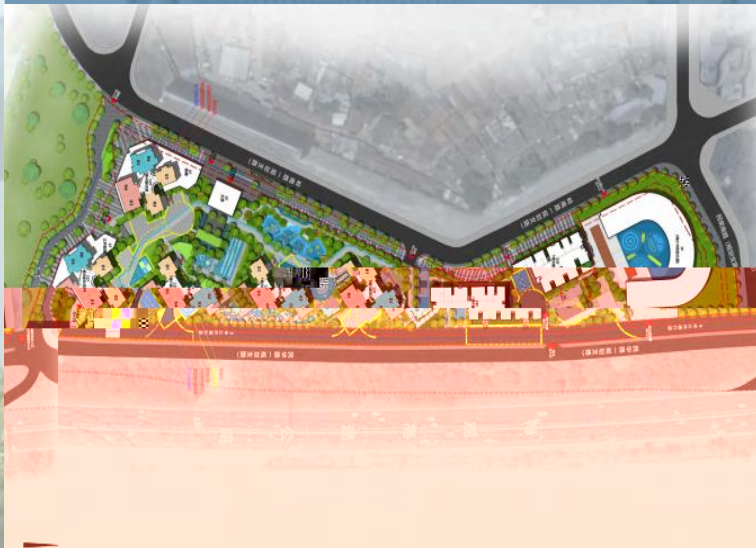

65859m<sup>2</sup>, 1000m<sup>2</sup>



63000m<sup>2</sup> 29460m<sup>2</sup>  
78000m<sup>2</sup>  
112000m<sup>2</sup>



● 2019 11 30

● 2020 11 30

● 2022 11 30

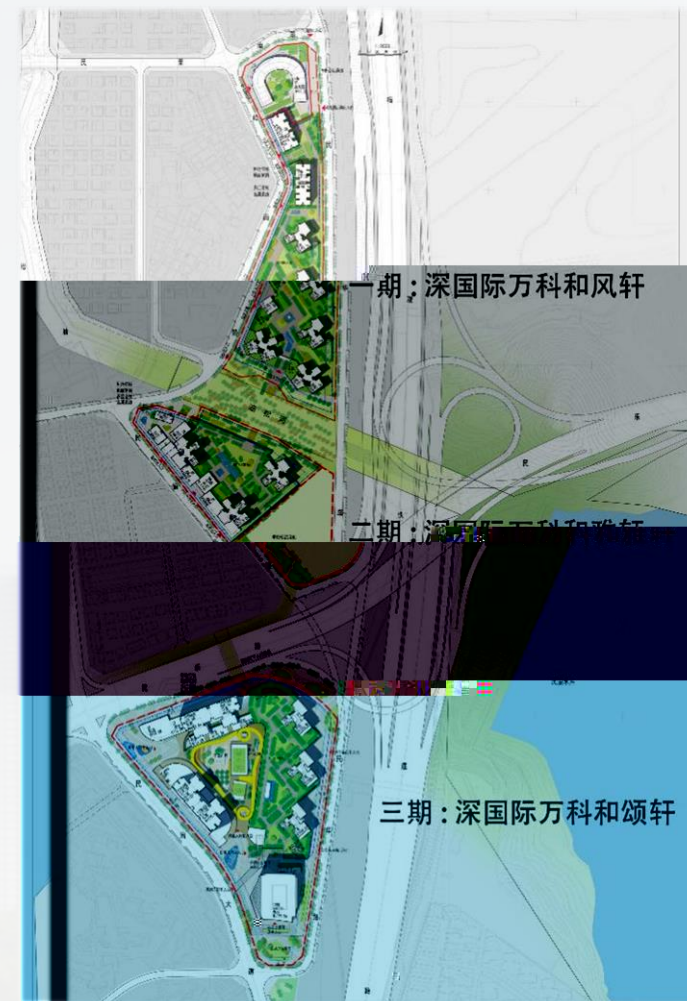

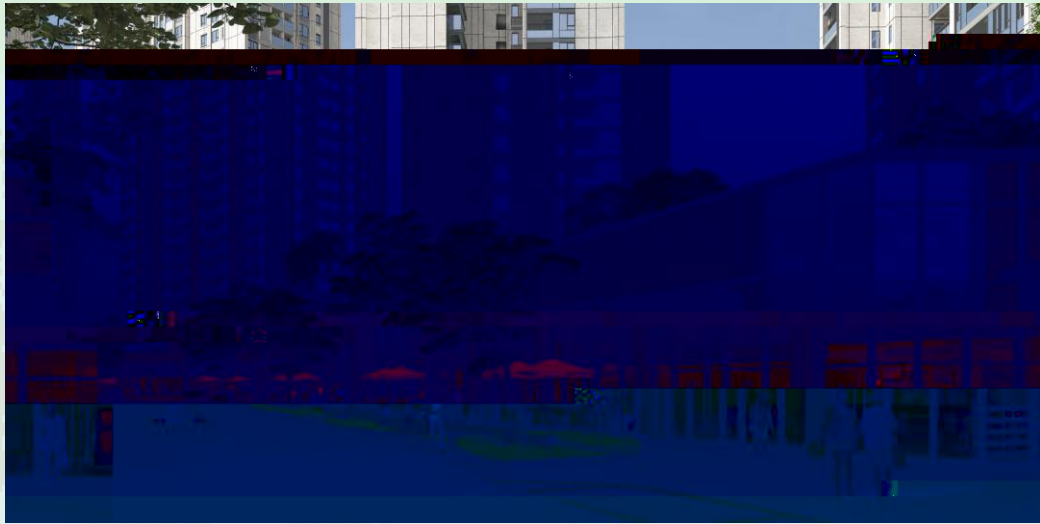





---

\*Aî,´

---

---

Ã

4



龙华新区民治办事处梅林关更新单元项目

## 代建合同

甲 方：深圳市深国际联合置地有限公司

乙 方：万科企业股份有限公司

签订日期：2017年10月

合同编号：\_\_\_\_\_

2017 10

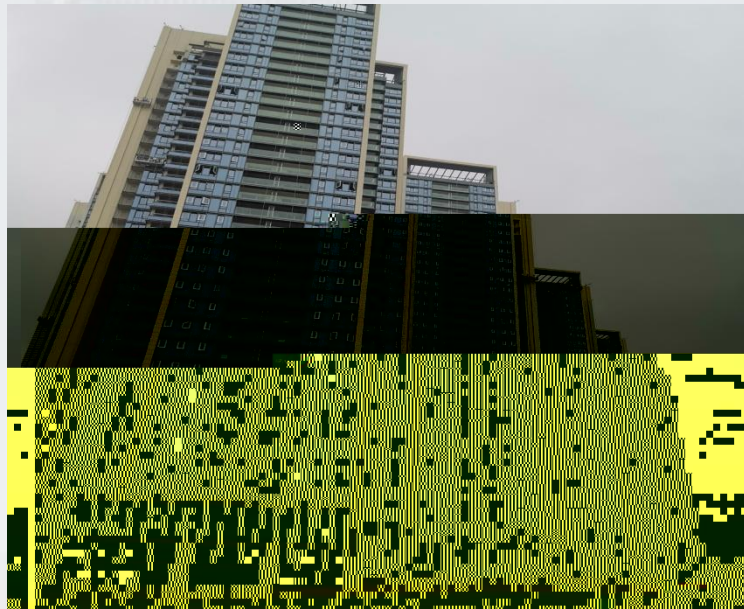

95%



1 A  
1 B  
2

18  
17  
25



80%

- 2014

2015 6 22

-2018 6 21

-2018 9 11

2019

2019

2019 4

2019

# 安全生产示范工地

深圳市龙华区住房和建设局

